

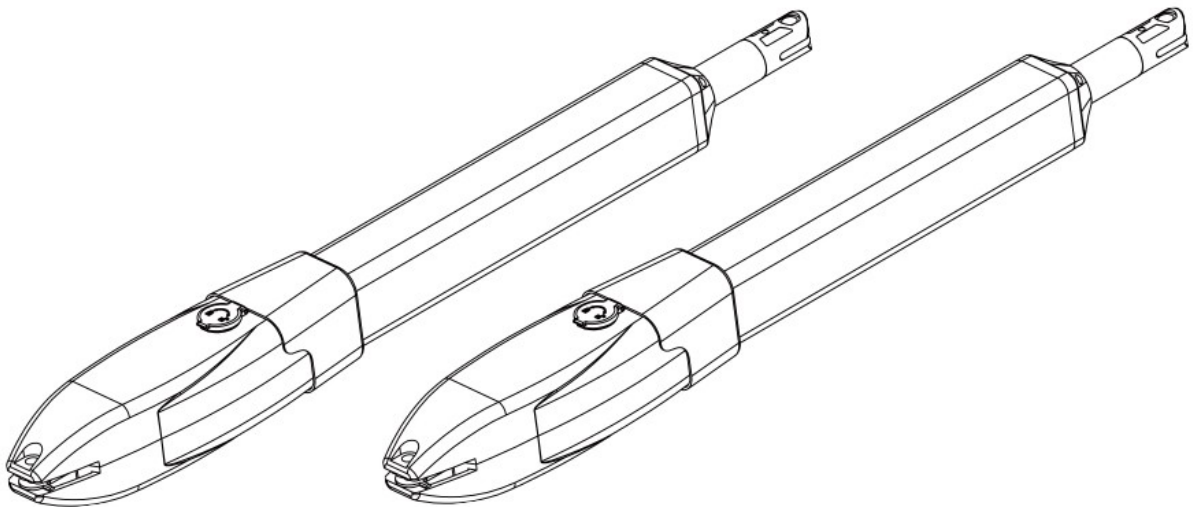

DC24V Heavy Duty Swing Gate Opener Manual



Attention

The manual should be read prior to the
installation process

CAUTION:

- This product must be installed by well-trained skilled personnel in compliance with the safety regulations the field of residential and commercial swing gate opener devices. Unqualified personnel may damage the instruments And cause harm to the public.
- Electric Power must be disconnected prior to installation, or performing any maintenance.
- Please read the manual carefully before installation. Incorrect installation or misuse of product may cause seriously damage to users and property.
- If the electric cable is damaged or broken, it must be replaced by a whole and properly insulated wires, to avoid electric shock or any hazardous environments.
- Keep the wireless transmitters out of children reach.
- Do not allow children or other individuals to stand by the path of the motor arms or the path of the gates while in operation.
- Do not use the remote wireless transmitters when the gates are out of sight.
- Do not install the products in corrosive, inflammable, and/or explosive environments.
- Avoid installing the motor arm where the override manual release key is exposed to the public .

Tools Required

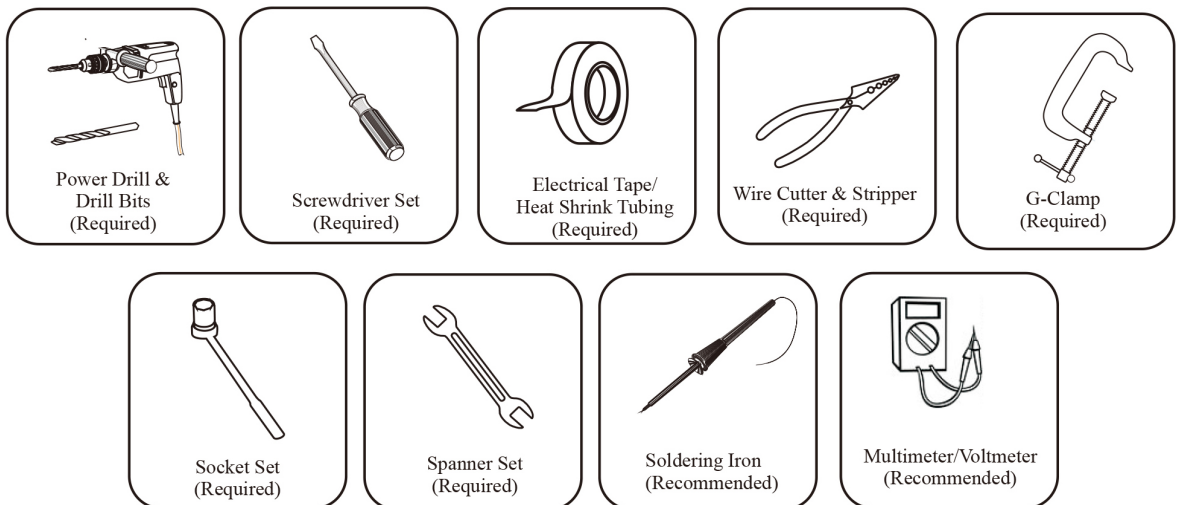

I. Products Configurations:

Products and accessories list

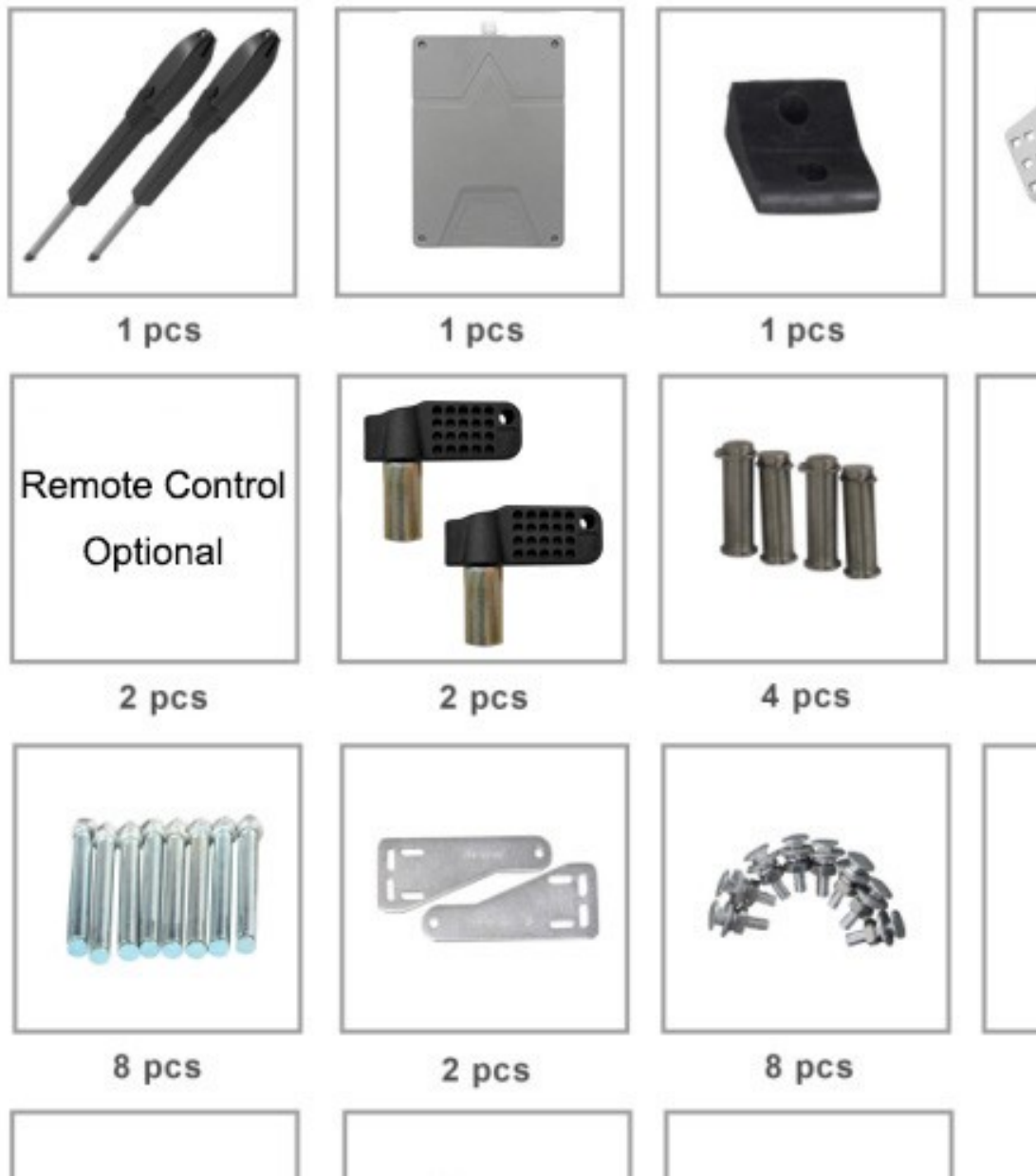

Figure 1

Nomenclature of Swing Gate Motor

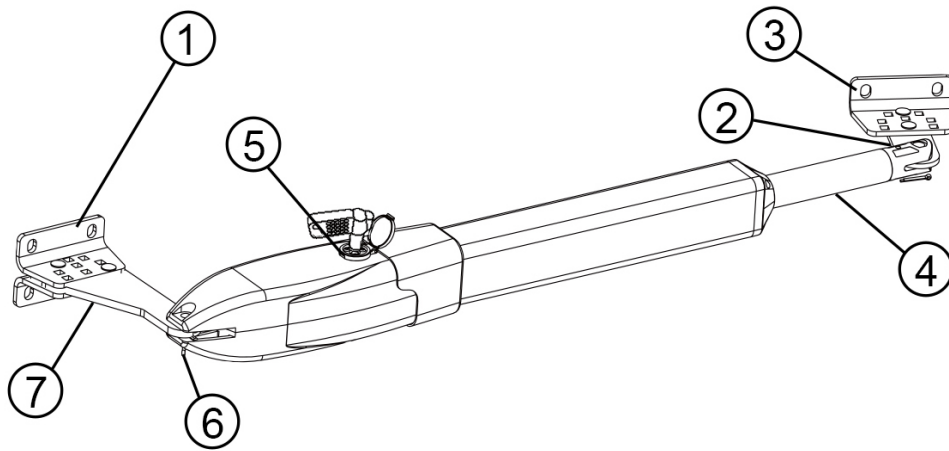

Figure 2

- Item 1:** Post Rear Fixed Bracket
- Item 2:** Extended Bracket Attached to Gate Structure
- Item 3:** Gate Front Fixed Bracket
- Item 4:** 400mm Extended Arm
- Item 5:** Motor Gear Box
- Item 6:** Power Cable
- Item 7:** Rear Bracket Fixed Plate Main Motor Arm

Override Manual Release Key

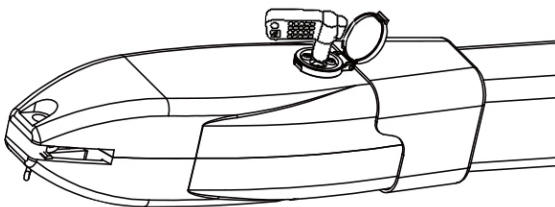

Figure 3

II. Swing Gate Opener Features & Options:

1. **In case of power failure:** Use the manual override key to release the clutch to open or close the gate manually.
2. **When Gate is Obstructed:** Gate stops .
3. **Optional:** The Gate Opener Controller can be connected to a solar system, a flash light warning, a photocell, back up battery, keypad and other access control devices.
4. **Speed Control:** Gate opening and closing speed can be adjusted.
5. **Gentle Start:** The Gate Opener is equipped with a soft start function.
6. **Auto Close:** The Gate Opener System is equipped with Auto close function with adjustable closing time delay.
7. **Single or Dual Gate:** Either Single or Dual Swing Gate can be opened.

8. **Multiple Remote Transmitters:** The Controller can easily accommodate several unique extra remotes to control the swing gate opener
9. **Battery Back Up:** DC 24V back up battery can be incorporated
10. **Optional Devices:** DC 24V Gate Lock ,photocell ,keypad , photocell,push button, large size or small size control box.
11. The Gate Opener can be configured to allow smooth noiseless operation.
12. The Gate Opener can be configured to enable open condition as default, or close condition as default depending on the placement of the provided hardware bracket brackets.

III. Technical Specifications

| | |
|---|---|
| Motor voltage: 24VDC 60W | Input power: 220VAC \pm 10%/120VAC \pm 10% |
| Rotational speed: 300 RPM | Arm's extended speed: 2.4 cm/s |
| Arm's max travel: 400 mm | Continue running time: 5 minutes |
| Max single-leaf length: 3.5meters | Max single-leaf weight: 350KG |
| Environment Temperature: -20°C ~ +50°C | Protection Class: IP55 |
| Max gate open angle: 110 degree | Dual Swing Gate Gross weight : 18.5kg |

IV. Preparing The Installation Site:

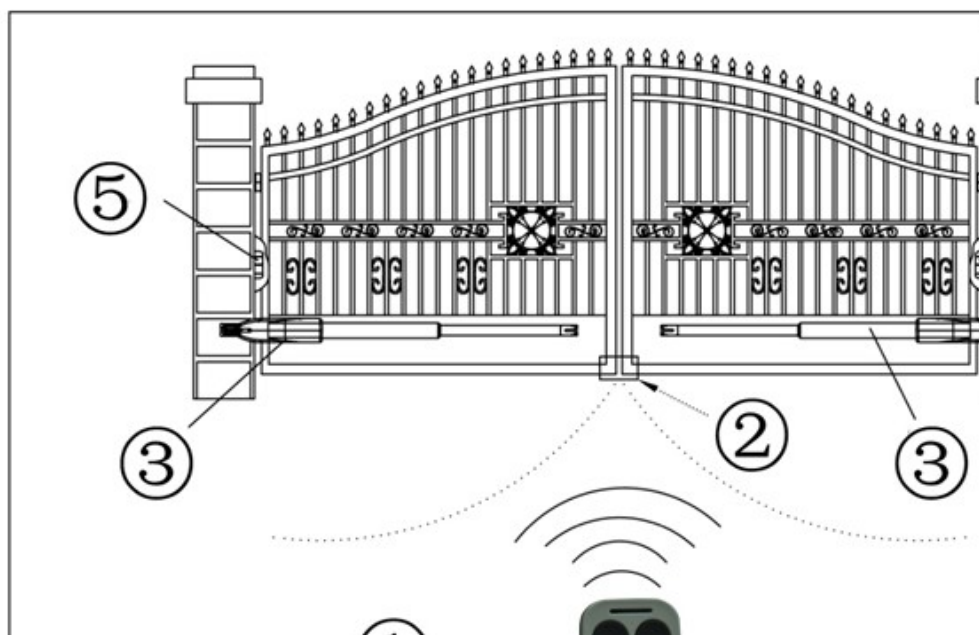

Figure 4

| Item | Nomenclature |
|----------------------------|-----------------------------------|
| 1. Wireless Transmitter | 4. Control Box |
| 2. Rubber Stopper | 5. Photocell Electric Sensor |
| 3. Swing Gate Opener Motor | 6. Flash Light Alarm (Optional) |

V. Rear Bracket Installation Alternatives to Gate Posts

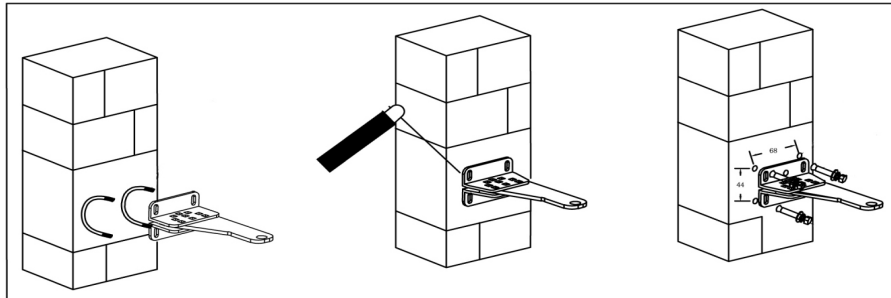

Figure 5

1. Construction Drill and Bolts, Figure 5 right:

- a. Drill 4 Holes of 8mm Diameter
- b. Insert the 4 Provided Concrete Bolts and Tighten Properly (Do not over tighten as you may strip the bolt out of the concrete or the brick)
- c. Place the Motor Connecting Bracket and Tighten with the Provided Screws

2. Construction Drill and Weld, Figure 5 middle:

- a. Drill 4 Holes of 8mm Diameter
- b. Locate the 4 Slotted Holes Post Bracket above the Drilled Holes
- c. Weld the Motor Bracket to the Post Bracket

3. Precast U Bolts, Figure 5 left:

- a. Locate the 4 Slotted Holes of the Post Bracket above the End of U Bolts
- b. Apply the Appropriate Screws
- c. Place the Motor Connecting Bracket and Tighten with the Provided Screws

4. Adjusting different angles of Rear Bracket Fixed Plate to fit different

Installing condition .

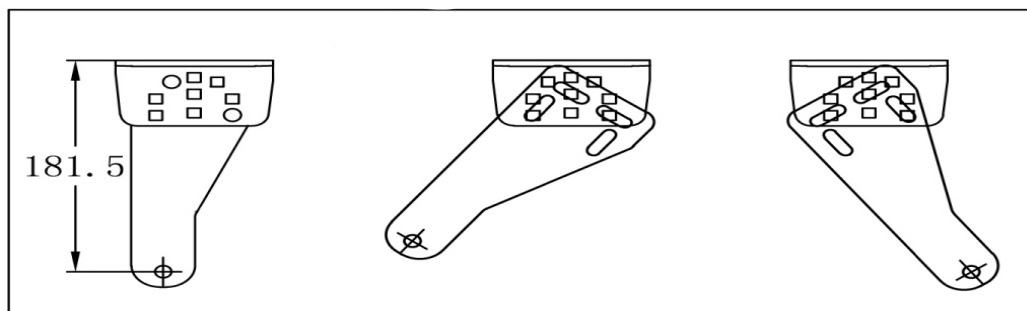

Figure 6

VI. Install the Motor Fixed-End to the Gate Post-Bracket

1. Ensure the Override Motor Key Post to face to the view of the public and away from the ground.

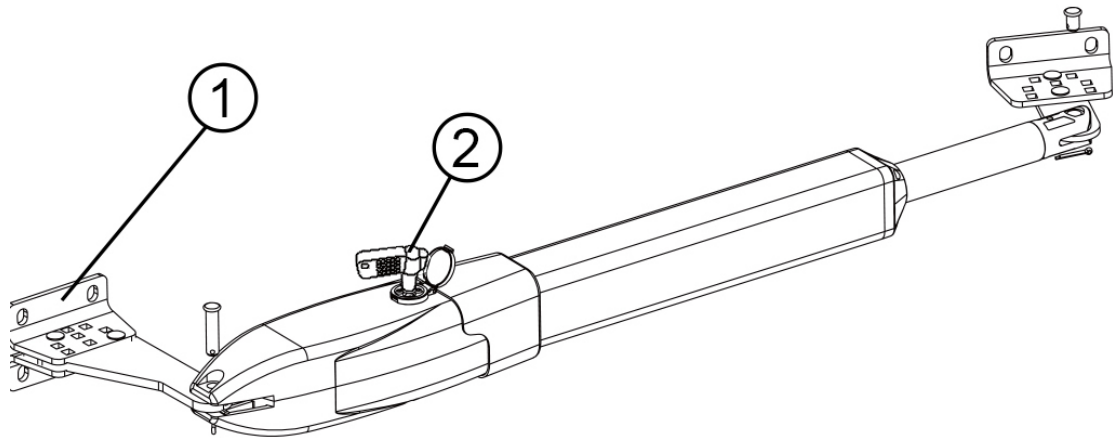

Figure 7

2. Once the Lock Pin and the Lock Washer are inserted between the Fixed End Motor and the Gate Post Bracket insure the power is not connected
3. Insert Override Manual Key
4. Turn the Key Clockwise to disengage the motor clutch to enable manual operation of gate.

VII. Considerations

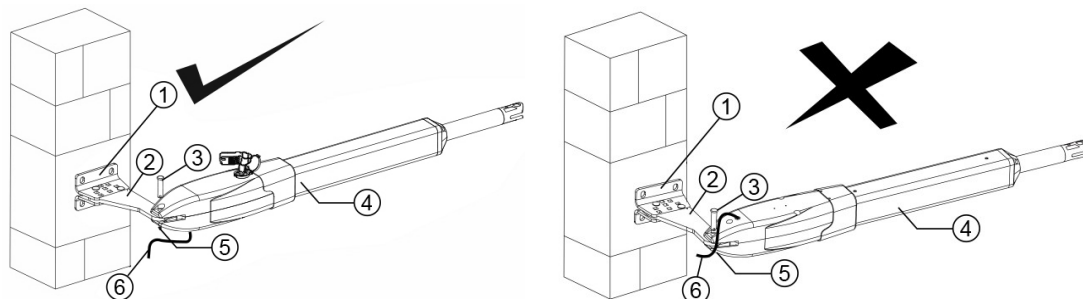

Figure 8

Figure 8 left, Power Cable And Manual Override Release Placed Correctly

- 1 Post Rear Fixed Bracket
- 2 Rear Bracket Fixed Plate Main Motor Arm
- 3 Lock Pin

Figure 8 right, Power Cable And Manual Override Release Placed Incorrectly

- 4 Rain Drainage Aperture
- 5 Washers and Lock Nuts
- 6 Power Cable

Notice : Incorrect Installation, Figure 8 right:

Cable must not be installed above the motor arm. It may pinch and strip the cable and causes electric shock. Also the manual override release must be located face to the view of the public. Follow correct installation as shown in Figure 8 left.

VIII. Installation of Extended or Retracted End Motor Arms to Gates:

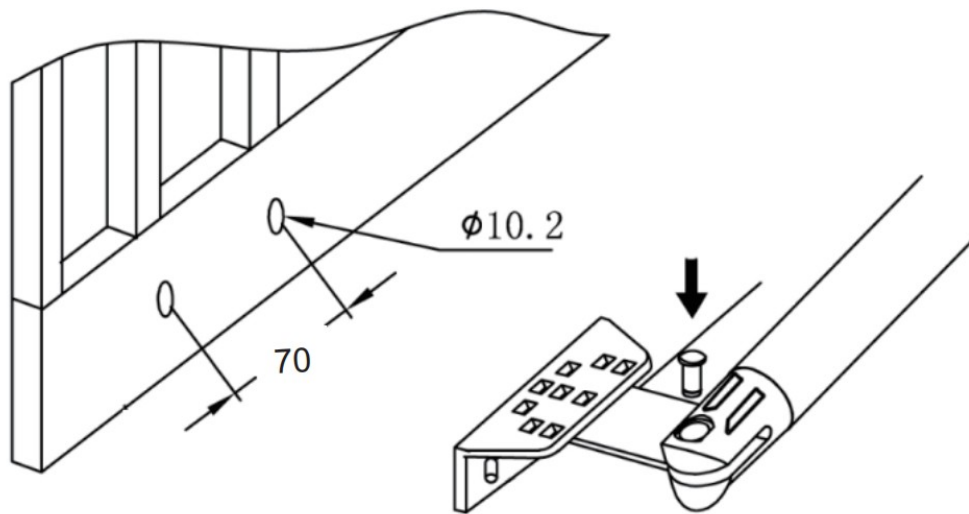

- A. Drill 2 Holes of 10.2mm Diameter With Space 70mm Between 2 Holes
- B. Locate the 2 Slotted Holes Gate Bracket above the Drilled Holes
- C. Place the End Motor Bracket to the Gate Bracket using the Appropriate Bolts and Tighten Properly(Please note these bolts used to fixed front bracket to the gate are not provided due to the thickness of each gate is different)
- D. Insert the Lock Pin and Clamping Washers

Brackets Height :

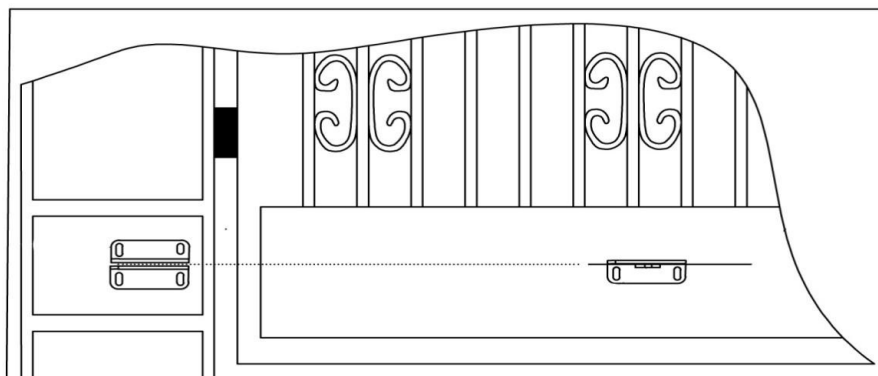

Ensure that the Post bracket height is in the same exact level with the gate bracket height. Failing to ensure accurate common heights will cause the motor arm to bend leading to failure. Also, the force to push or pull the gate will be reduced causing the motor to open or close the gates with difficulty or may not operate successfully at all. Severe different in height will damage the motor and the motor arm.

Configuration of Normally Closed Gate Opener System

Pull-To-Open Installation Mode:

The installation position of the bracket is very important. Please refer to the figure to measure according to the angle you need to open. Unit: mm (for example: A is 150mm, B is 176mm. At this time, the maximum opening angle of the gate is 100°), determine the center point of the shaft and mark it.

